



ادفانس للصناعات المعدنية ذ.م.م.
ADVANCE METAL INDUSTRIES L.L.C.

Fire Doors & Frames



Copyright reserved for ADVANCE METAL

"Due to continuous progress and product improvement, ADVANCE METAL reserves the right to make changes without notice"

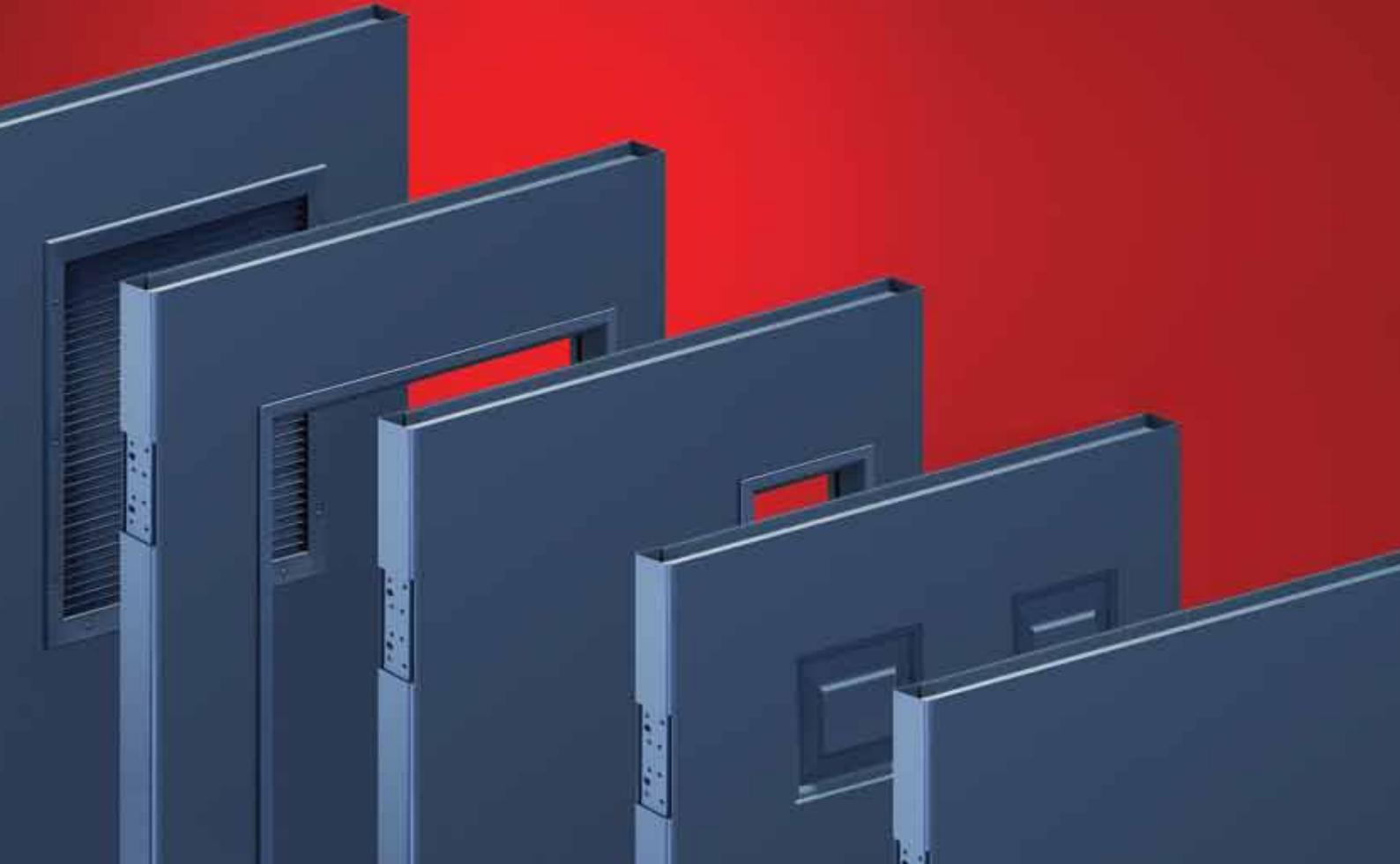



DISCLAIMER OF WARRANTIES: ADVANCE METAL products are designed on “SDI”, “NFPA”, technological data in the interest of improving the safety for the public benefit. ADVANCE METAL disclaims any liability for any personal injury, loss of life, property damage, or other damage of any nature whatsoever, whether special, indirect, consequential or compensatory, direct or indirectly resulting from any accident, regardless of legal theory. In no event shall ADVANCE METAL’s liability exceed the amount paid by the customer / contractor to that individual product cost OR US\$1000/- whichever is lesser, regardless of legal theory.

Note: Steel Doors once install, needs to be strictly maintained for every month and operation performance should be recorded by trained engineer or concern department experts, as per the Operation and Maintenance manual.

BREAKS

Fire & Smoke Path



ADVANCE METAL Steel Doors are design based on SDI and NFPA technological data in the interest of improving the safety for the public benefits.

Today as per the BOCA International standards, building safety is a demandable choice by the public, in case of fire accidents. ADVANCE METAL fire rated Steel Doors are produced with the toughest UL and SDI standards to prevent any spread of smoke fire breakup. For more details about ADVANCE METAL UL listed products contact on Tel: +9716 7436900

FIRE RATED STEEL DOOR SPECIFICATIONS

GENERAL

Scope:

This specification applies to standard steel doors as shown on the plan and door schedules and as manufactured by ADVANCE METAL INDUSTRIES L.L.C.

Quality Assurance:

ADVANCE METAL will provide doors in compliance with ANSI/SDI-100 requirements. ADVANCE METAL will provide fire rated doors labeled and listed by Underwriters Laboratories Inc. (or) warringtonfire mideast.

PRODUCT

Door Construction:

45mm ($1\frac{3}{4}$ ") thick full flush construction with the details confirming to SDI-111A-EDGE considered.

Manufactured from cold rolled steel sheets to ASTM A366 or from galvanized steel to ASTM A526. Available in nominal 1.2mm (18ga.) or 1.5mm (16ga.).

Vertical edges are interlocked.

1.5mm (16ga.) deep end channels at top and bottom of door for lasting integrity.

Hardware reinforcing in accordance to ANSI, SDI, NFPA standards requirements.

Tested according to UL10(B) and labelled up to 3 hours.

Available with wide range of glass light and louver preparations.

Fire rated, Labeled: Available in sizes up to 4'x8' single and 8'x8' double. larger sizes are also available with oversize certification.

HARDWARE PREPARATION

Hinge Preparation:

ADVANCE METAL will provide doors with 4.0mm thick steel hinge reinforcements welded to the doors in compliance with SDI-100. Standard hinge preparation is to be 41/2"x4" for regular weight 0.134" thick hinge, three preparations through 2286mm (7'6") height and four preparations over 2286mm (7'6") and up to 3048mm (10') height in compliance with NFPA 80.

Lock Face Plate Preparation:

ADVANCE METAL will provide Doors with 3.0mm thick steel lock face plate reinforcement with tapped holes welded to the Doors.

Standard lock preparation is to be provided in compliance with ANSI A115.2.

Closer and Other Reinforcement:

Advance Metal will provide all doors with minimum 2.0mm (14gauge) reinforcement as necessary to support the scheduled hardware in compliance with ANSI/SDI-100. Drilling and tapping for surface applied hardware to be performed at the building site by others.



Glazing:

Doors are to be provided with steel channel glazing beads for installation of glazing. Installation of glazing by others.

Painting:

After fabrication Door thoroughly cleaned (to assure proper adhesion) and polyester powder coated finish applied. Wooded finish paint will be provided as a optional finish.

FIRE PROTECTION:

Labeled fire rated Door tested in accordance with UL (or) Warringtonfire-mideast with rating as specified in the plans and door schedule. Fire door frames are to be manufactures by Advance Metal in accordance with the approved procedures issued by UL (or) Warringtonfire-mideast.

Labels:

Fire rated Door shall bear the appropriate fire labels.

Execution:

Installation of the frames plumb, square and in true alignment in compliance with SDI-122. Installation and troubleshooting guide for standard steel doors and frames.

FIRE DOOR TYPES - DF

AM-100 Series - Honeycomb core door
AM-200 Series - Polystyrene core door
AM-300 Series - Stiffened Door with fiberglass insulation
AM-400 Series - Stiffened Door with Rock wool insulation
AM-500 Series - Polyurethane core door

AMEM-100 Series - Embossed steel doors-honeycomb
AMEM-200 Series - Embossed steel doors (Fire rated) honeycomb

AMSS-100 Series - Stainless steel hollow metal honeycomb core door

AMSS-200 Series - Stainless steel hollow metal door

AMSS-300 Series - Stainless steel hollow metal door with fiberglass insulation

AMSS-400 Series - Stainless steel hollow metal door with fiberglass insulation

AMSS-500 Series - Stainless steel hollow metal door Polyurethane door

Single Door



Double Door



TYPICAL DOOR TYPES

Double Door Elevation

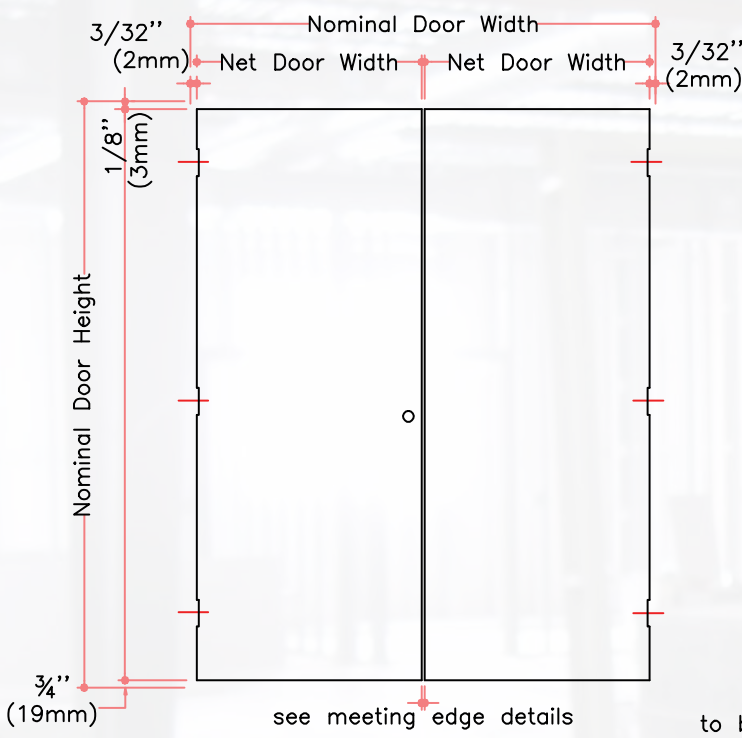

Single Door Elevation

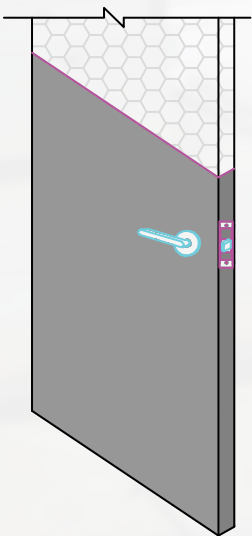
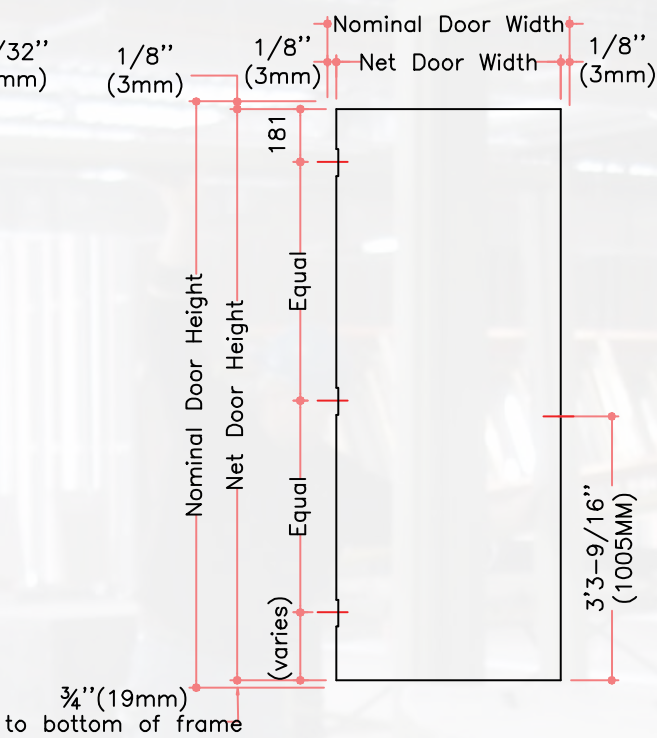

AM-100 Series
Honey Comb Core

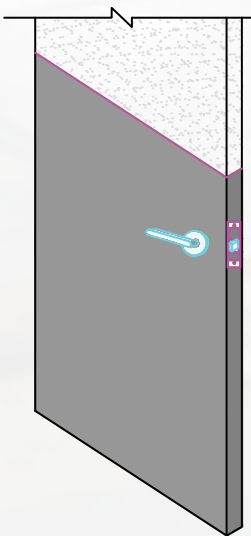

AM-200 Series
Polystyrene Core

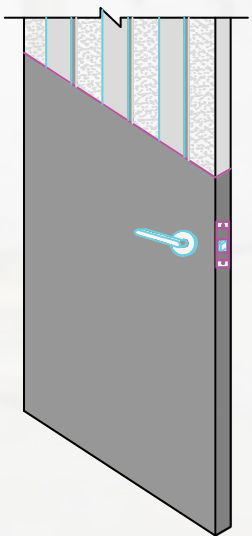

AM-300 Series
Steel stiffened with
Fiberglass

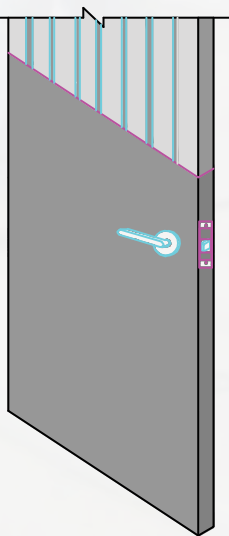

AM-400 Series
Steel stiffened with
rock wool

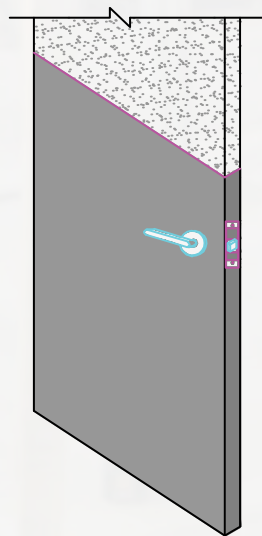

AM-500 Series
Polyurathane Core

TYPICAL ELEVATIONS

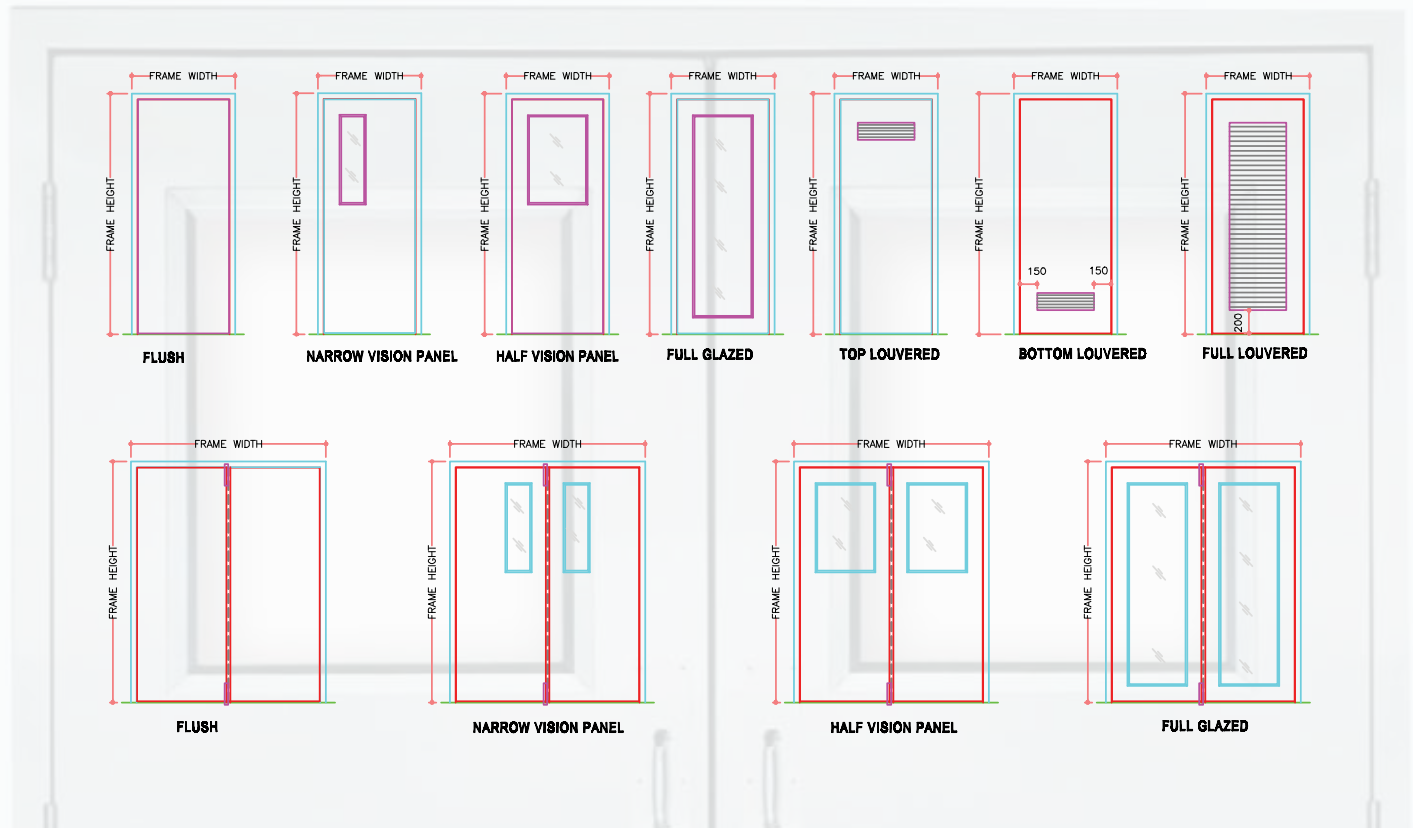

AM-100 Series: Pre-foamed Honey Comb bonded to both Door skins using a heated power press thus ensuring maximum adhesion and flat warp and distortion free panel.

AM-200 Series: Pre-foamed polystyrene slab of 18Kg/m³(1.12pcf) density, filling the inside of the door and secured to face skins with adhesive.

AM-300 Series: Constructed using 0.8mm (22 gauge) thick vertical steel stiffeners welded to each face of the door at 100mm centers and spaced 190mm centers. Voids filled with fiberglass insulation.

AM-400 Series: Constructed using 0.8mm (22 gauge) thick vertical steel stiffeners welded to each face of the door at 100mm centers and spaced 190mm centers. Voids are filled with rock wool insulation.

AM-500 Series: Foamed-in-place polyurethane core exceeding 35Kg/m³(2.18 pcf) compressed density, entirely filling the inside of the door.

FIRE RATED STEEL FRAME SPECIFICATIONS:

1.0 GENERAL:

Scope:

This specification applies to standard steel frames as shown on the plan and door schedules and as manufactured by Advance Metal Industries LLC.

Quality Assurance:

Advance Metal will provide frames in compliance with ANSI/SDI-100 requirements. Advance Metal will provide fire rated frames labeled and listed by UL (or) Warringtonfire-mideast.

PRODUCT:

Frame Construction:

Frames are constructed of 1.2mm (18 gauge) or 1.5mm (16 gauge) or 2mm (14 gauge) or 2.5mm (12 gauge) commercial quality cold rolled steel ASTM A366 or hot dip galvanized steel sheet ASTM A526, G90 for doors of either 45mm (1³/₄"") or 35mm (1³/₈"") thickness with the details conforming to SDI-111A. All bends shall be formed with a true sharp radii.

Welded Frames:

Welded frames will be factory assembled, face welded and ground smooth. All welded frames will include the appropriate anchors to match the wall construction they are intended to be installed.

Knocked Down Frames:

All KD frames will include the appropriate anchors to match the wall construction, they are to be installed with appropriate reinforcement.

Architectural Entrances, Sidelites and Borrowed Lites:

Advance Metal will provide all architectural entrances, sidelites and borrowedlites fabricated from 1.5mm(16gauge) cold rolled or hot dipped galvanized steel sheet. Construction, preparations and profiles to match masonry frames. All mullion sections to be closed. All joints and corners of the assembly shall be face welded and ground smooth. Advance Metal will provide steel channel glazing beads for all areas with glass. Field joints shall be permitted when the size of the total assembly exceeds shipping limitation.

Hardware Preparation:

Hinge Preparation:

Advance Metal will provide frames with 4.0mm thick steel hinge reinforcements welded to the frames in compliance with SDI-100. Standard hinge preparation is to be 41/2"x4" for regular weight 0.134" thick hinge, three preparations through 2286mm(7'6") height and four preparations over 2286mm (7'6") and up to 3048mm(10') height in compliance with NFPA 80.

Strike Preparation:

Advance Metal will provide frames with 3.0mm thick steel lock strike reinforcement with tapped holes welded to the frames. Standard strike preparation is to be for 2³/₄" or 4⁷/₈" strike in compliance with ANSI A115.1 or A115.2



Closer and Other Reinforcement:

Advance Metal will provide all frames with minimum 2.0mm(14 gauge) reinforcement as necessary to support the scheduled hardware in compliance with ANSI/SDI-100. Drilling and tapping for surface applied hardware to be performed at the building site by others.

Plaster Guard:

Advance Metal will provide 1.2mm thick steel plaster guard or mortar boxes at the back of hardware cut-outs in the frames.

Glazing:

Frames are to be provided with steel channel glazing beads for installation of glazing. Installation of glazing shall be by others.

Painting:

After fabrication frames thoroughly cleaned (to assure proper adhesion) and polyester powder coated finish applied. Wood-en finish paint will be provided as an optional finish.

FIRE PROTECTION:

Labeled fire rated door frames tested in accordance with UL (or) Warringtonfire-mideast with rating as specified in the plans and door schedule. Fire door frames are to be manufactured by Advance Metal in accordance with the approved procedures issued by UL (or) Warringtonfire-mideast.

Labels:

Fire rated frames shall bear the appropriate fire labels.

EXECUTION:

Installation of the frames plumb, square and in true alignment in compliance with SDI-122 installation and troubleshooting guide for standard steel doors & frames.

STEEL DOOR FRAME ELEVATION

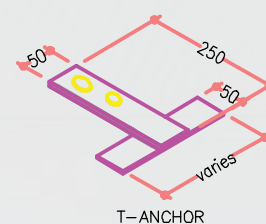
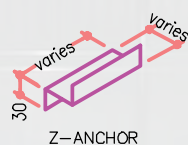
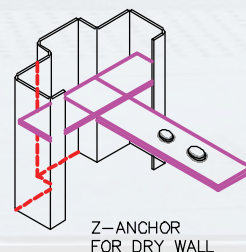
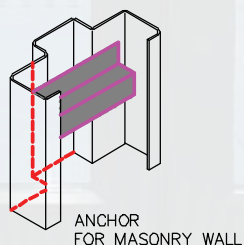
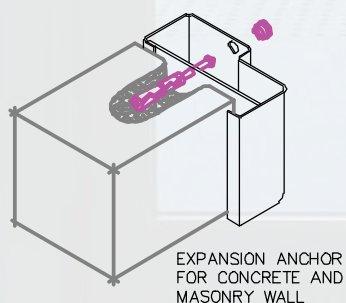
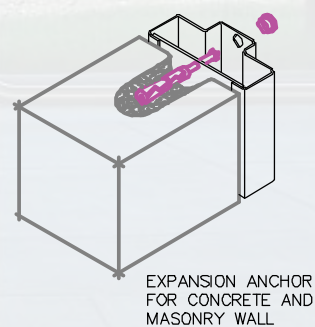
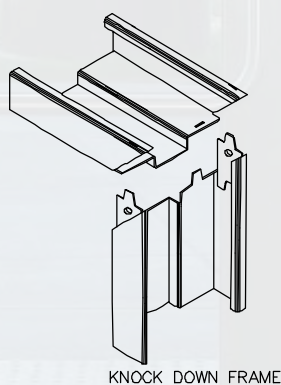
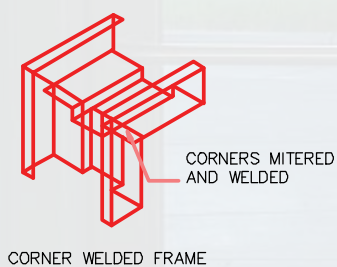
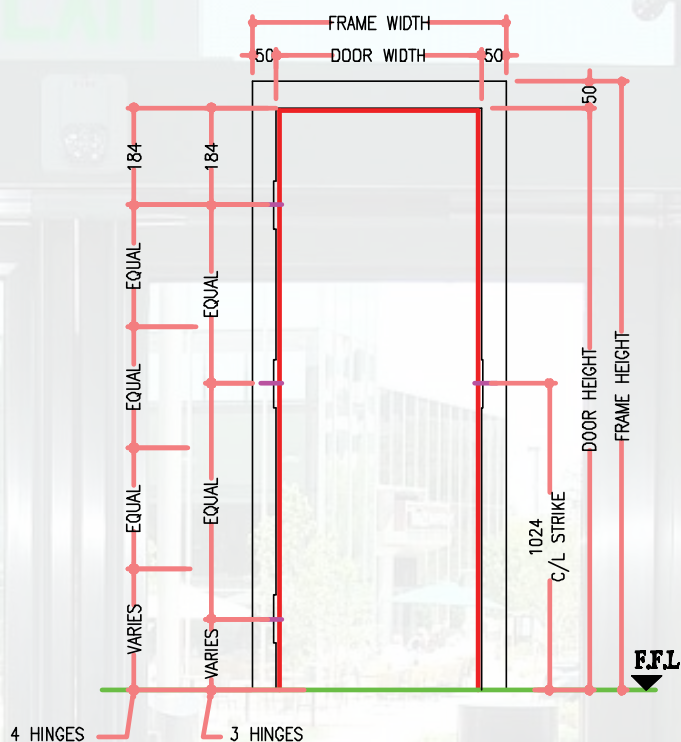

TYPICAL PROFILE DETAIL



Labeled frames shall be fabricated from cold rolled or galvanized steel sheet. Bends shall be brake formed to assure true, sharp radius, and to minimize camber. Labeled Masonry and Dry Wall frames can be shipped either knockdown or welded. Transom frames shall be shipped welded only. Standard hardware preparations for labeled fire door frames for 45mm. (1 3/4") thick doors Max. 3Hrs. Fire Label provided.

FRAME PROFILES

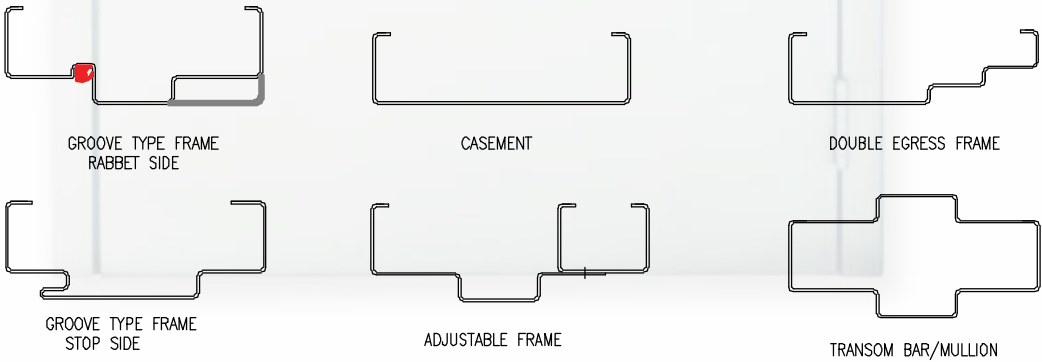

TYPICAL DETAILS

TRANSOM FRAMES

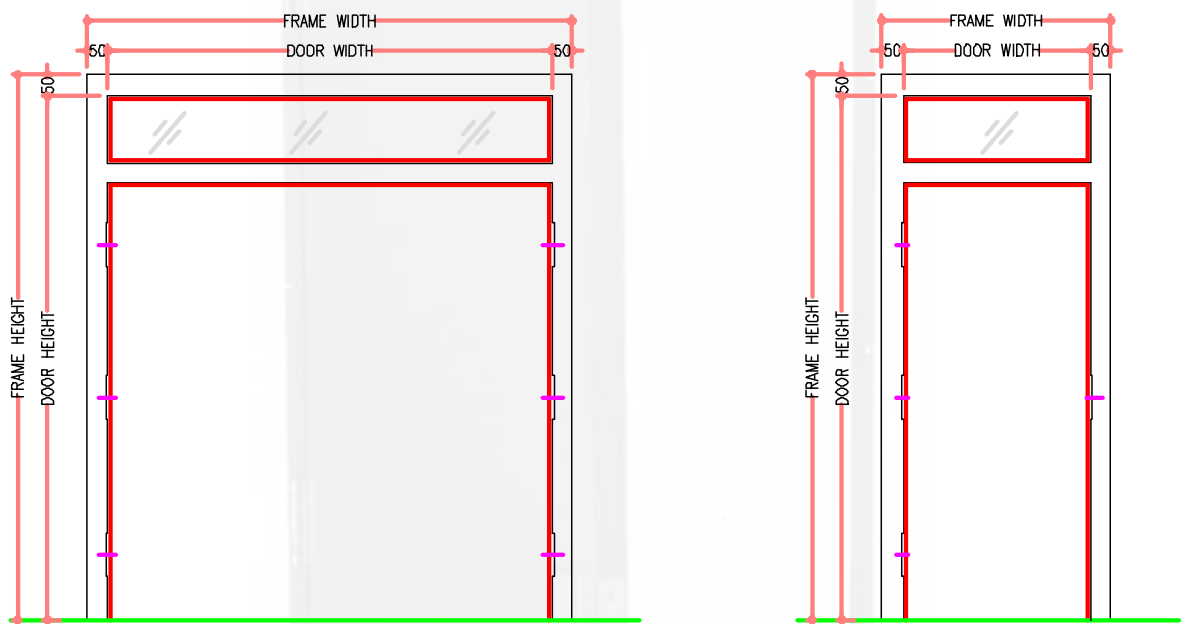

- Max. Overall Frame Size:
1320x3100mm. for Single;
2540x3100mm. for pair.
- Transom Frames must be shipped from factory as set-up welded units with panels installed.

FIRE WINDOW FRAMES

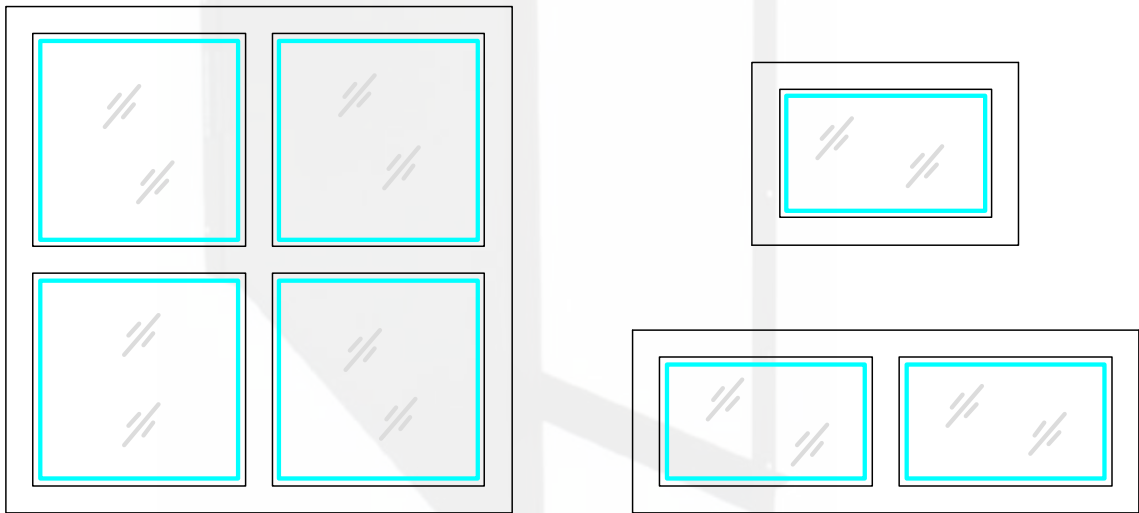

TYPICAL ELEVATIONS



Transom side light frames may be of 1.5mm. (16ga.) or 2.0mm. (14ga.) steel sheet.

Maximum Frame Size:

3650x3048mm. or 3048x3650mm. for masonry wall installations and

3650x3048mm. for dry wall installations.

Maximum Door Opening Size:

1220x2438mm. for Single,

2438x2438mm. for Pair.

Jamb Depth:

120mm. min. thru 323mm. max.

(4 $\frac{3}{4}$ " thru 12 $\frac{3}{4}$ "")

Maximum Throat Opening:

114mm. for masonry wall; 92mm. for dry wall.

PRODUCT RANGE

HOLLOW METAL DOORS AND FRAMES (HMD):

SR.No.	SERIES	PRODUCT
1	HMD	Steel Doors Non Fire Rated
2	HMD (FR)	Steel Doors Fire Rated
3	HMD AC	Sound Proof (Acoustic) Doors and Frames
4	HMD BU	Bullet Proof Doors and Frames
5	HMD XR	X-ray Proof Doors and Frames
6	HMD GA	Gas Tight Doors and Frames (Air Tight)
7	HMD TR	Transom and Sidelite Frames
8	HMD DE	Detention (Cell Doors) Doors and Frames
9	HMD EM	Embossed Steel Doors and Frames
10	HMD DU	Dutch Doors and Frames
11	HMD AC	Access Doors and Frames
12	HMDWI	Window Frames and security screens.
13	HMD PR	Prepainted Doors and Frames (Low Cost Doors)
14	HMD SS	Stainless Steel Doors and Frames
15	HMD TO	Toilet Partitions
16	HMD SE	Seamless Doors and Frames
17	HMD FO	Folding Doors

SPECIAL USAGE DOORS (SUD):

SR.No.	PRODUCT
1	Security Doors and Frames
2	Blast Proof Doors and Frames (Blast Resistance)
3	Sliding Doors
4	Sliding Gates
5	Oversize (Panelized Doors) with Pass Doors
6	Security Wall System and Ceilings (Metal Partitions)
7	Fire Rated Sliding Doors
8	Hanger Doors
9	Fiberglass Doors and Frames (Corrosion Resistance Doors)
10	Roof Hatches

The unexposed face of the doorsets to fire after 120 minutes of testing



The exposed face of the doorsets to fire immediately after testing



Picture of Advance Metal sample doors tested in a private lab for pre-assessment and pre-qualification procedures.

DOOR HANDING CHART

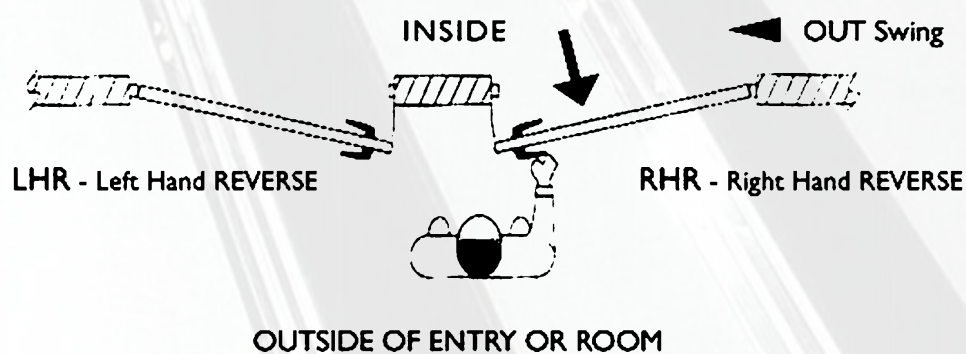
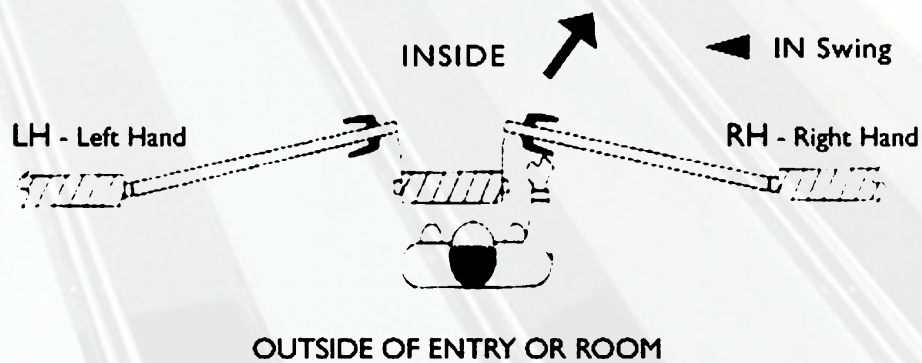

THE HANDING OF THE DOOR IS ALWAYS DETERMINED FROM THE OUTSIDE

HERE ARE A FEW RULES TO FOLLOW

- The outside of the exterior door is the street or entrance side
- The outside of a room door is the hall side
- The outside of a closet door is the room or hall side

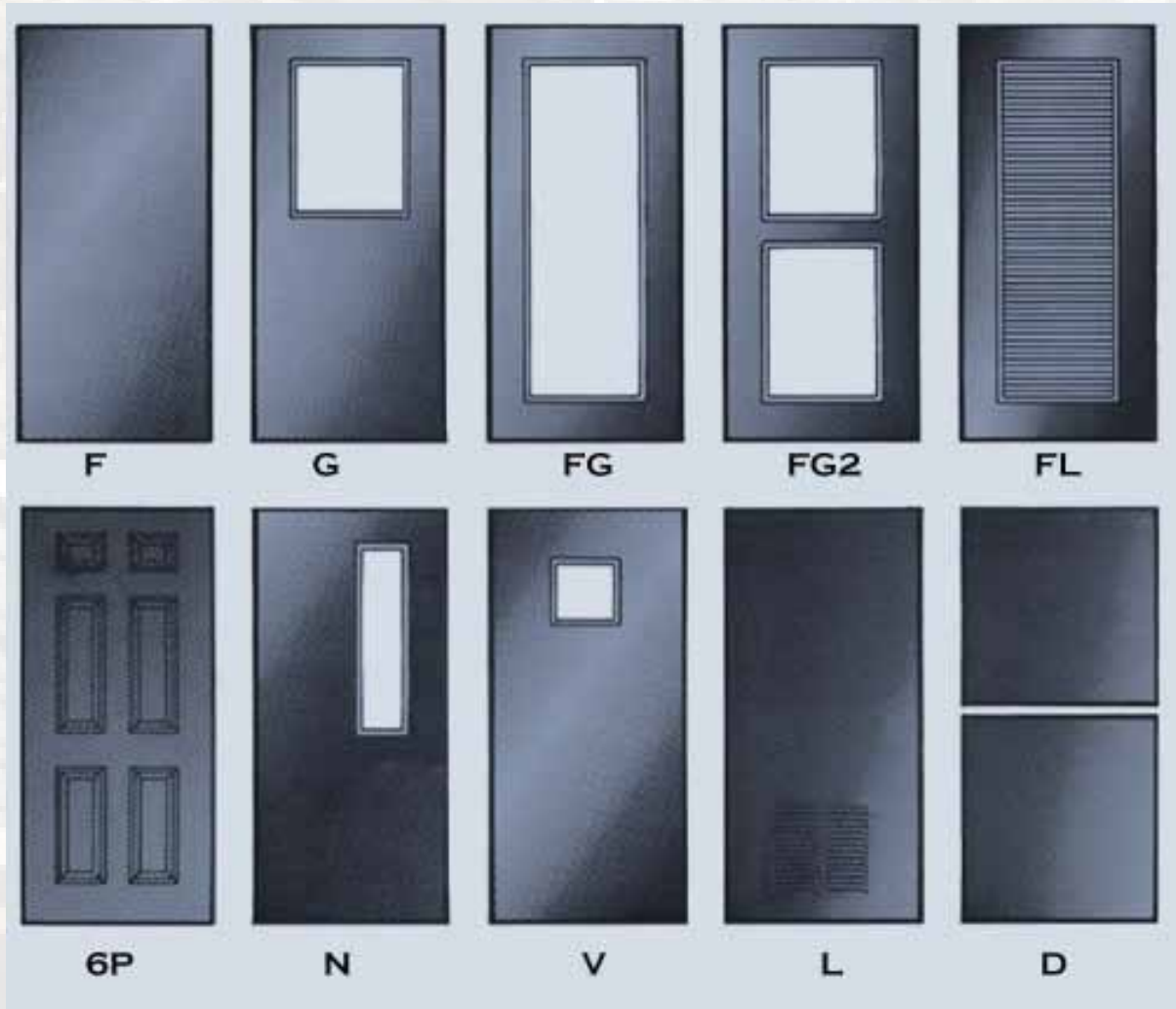

ادفانس للصناعات المعدنية ذ.م.م.

ADVANCE METAL INDUSTRIES L.L.C.

P.O.Box: 9159, Tel.: 06-7436900 / 06-7439600,

Fax: 06-7436700, Ajman - U.A.E.

E-mail: admetal@airmaster.ae

www.admetal.ae